



DEVELOPMENT VARIANCE PERMIT NO. DVP00250

BROOKS LANDING CENTRE INC.
Name of Owner(s) of Land (Permittee)

Civic Address: 2000 ISLAND HIGHWAY N

1. This development variance permit is issued subject to compliance with all of the bylaws of the municipality applicable thereto, except as specifically varied by this permit.
2. This permit applies to and only to those lands within the municipality described below, and any and all building structures and other developments thereon:

Legal Description:

LOT A, SECTION 1, NANAIMO DISTRICT, PLAN VIP84049

PID No. 027-297-551

3. The City of Nanaimo "SIGN BYLAW 1987 NO. 2850" is hereby varied as follows:
Section 3(6) prohibits a sign or portion thereof that extends or projects above the roofline of a building. The fascia sign is not located on an architectural feature, therefore a variance has been approved to allow the 'ON' portion of the fascia sign to extend 0.56m above the roofline of the building.
4. The permittee, as a condition of the issuance of this permit, shall develop the land described herein strictly in accordance with the following terms and conditions and provisions and in accordance with any plans and specifications attached hereto which shall form a part thereof.

Schedule A Location Plan

Schedule B Proposed Elevation with Sign

Schedule C Sign Detail

5. If the permittee does not substantially commence the construction permitted by this permit within two years of the date of this permit, this permit shall lapse.
6. This permit prevails over the provisions of the bylaw in the event of conflict.
7. This permit is not a building permit nor does it constitute approval of any signage. Separate applications must be made for a building permit and sign permit.

AUTHORIZING RESOLUTION PASSED BY COUNCIL
THE 19TH DAY OF JANUARY, 2015.



D/ Corporate Officer
Kristin King



Date

GN/lb

Prospero attachment: DVP00250

Development Variance Permit DVP00250
 2000 Island Highway North
 Schedule A
 Location Plan

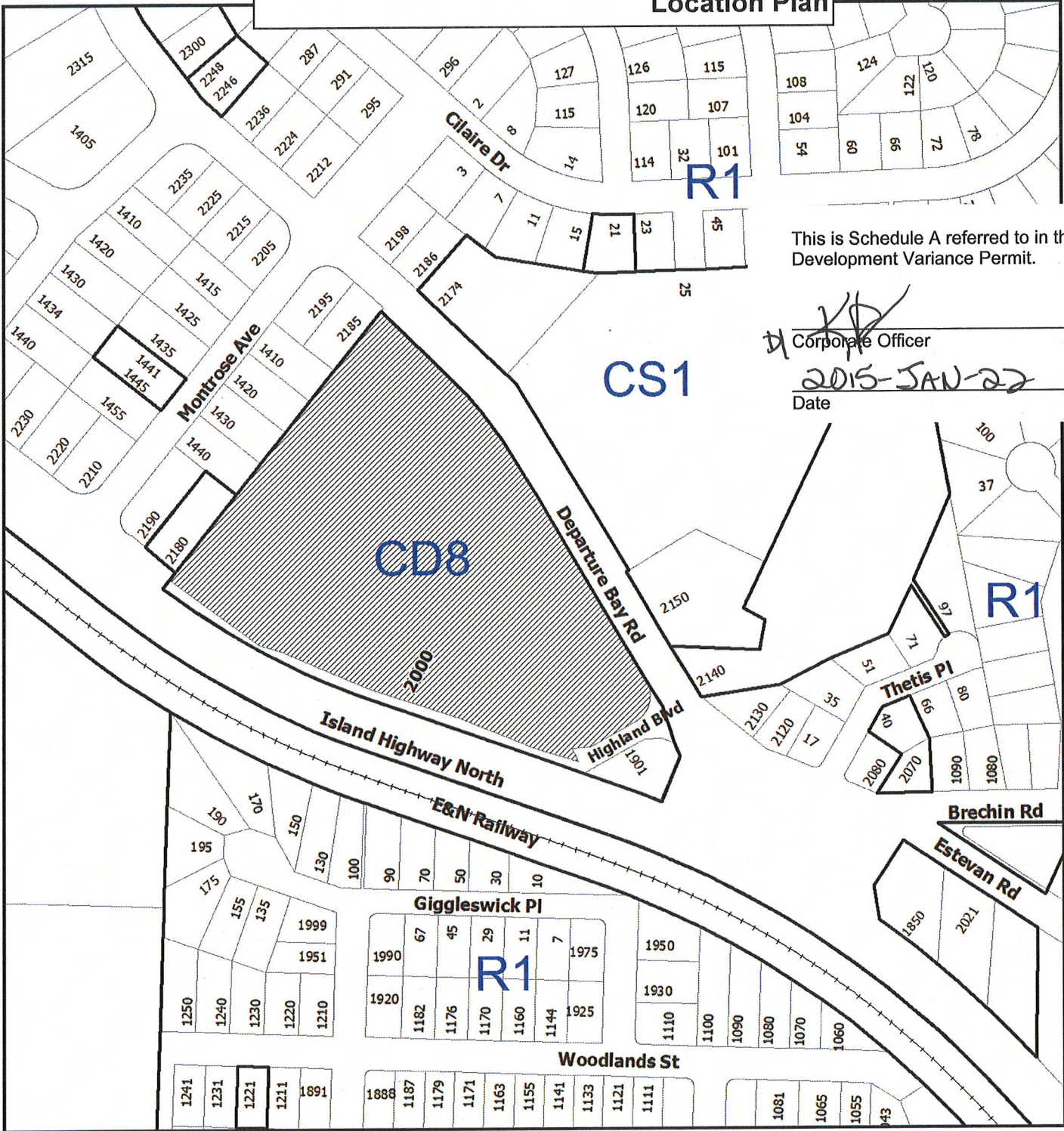

This is Schedule A referred to in the Development Variance Permit.

[Signature]
 Corporate Officer
 2015-JAN-22
 Date



DEVELOPMENT VARIANCE PERMIT NO. DVP00250

LOCATION PLAN

Civic: 2000 Island Highway North
 (Brooks Landing)

 **Subject Property**

This is Schedule B referred to in the Development Variance Permit.

KP
 J1 Corporate Officer
 2015-JAN-22
 Date

BEFORE



BEFORE (SIDE ELEVATION)



FRONT & SIDE CORNER ELEVATION

PLEASE NOTE: SIZE OF SIGNAGE IS IN RELATION TO SURROUNDINGS IS APPROXIMATE. THIS OVERLAY IS INTENDED FOR LOCATION PURPOSES ONLY AND MAY NOT ACCURATELY REFLECT THE SCALE OF THE PROPOSED SIGN TO SURROUNDINGS. A SITE SURVEY IS REQUIRED FOR EXACT PROPORTIONS.

AFTER



PROPOSED SIGN - 6' LOGO ON FRONT, (4' LOGO ON SIDE ELEVATION IS EXISTING)

ATLAS
 SIGN & AWNING
 26697 Gloucester Way, Langley, BC V4W 3S4
 Ph: (604) 856-7983 Fax: (604) 856-7625
 or call toll free (800) 882-1018

DATE: Dec 1, 2014
 JOB: 2859
 SALES: Lea Olom
 DESIGN: J Crouch
 SCALE: nls
 VOLTAGE: 120v
 PAGE: 2 of 3

Customer Approval



Fluorescent, Neon and HID lamps contain Mercury. Dispose of these lamps according to Local, Provincial, State or Federal Laws.

save on foods

SAVE ON FOODS - 947 Brooks Landing
 #103 - 2000 Island Hwy, Nanaimo BC V9S 5W3

Development Variance Permit DVP00250
 2000 Island Highway North

Schedule B

Proposed Elevation with Sign

This is Schedule C referred to in the Development Variance Permit.

[Signature]
 Corporate Officer
 2015-JAN-22
 Date

Section 'D'

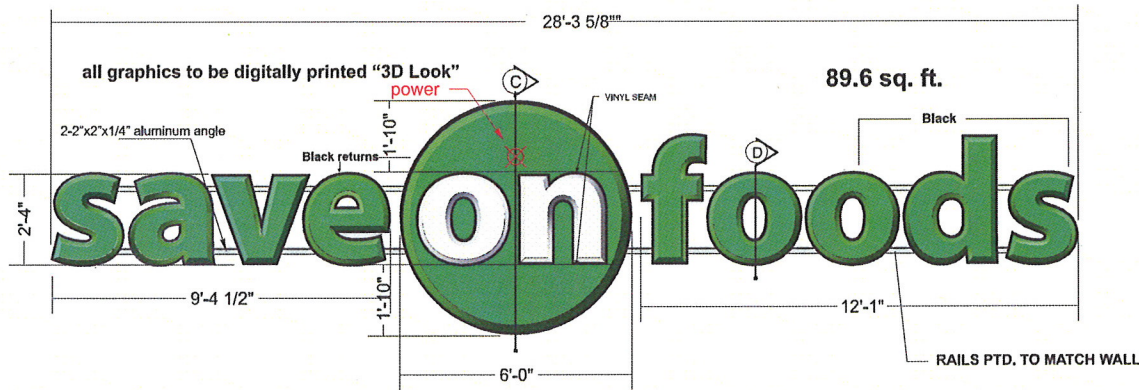
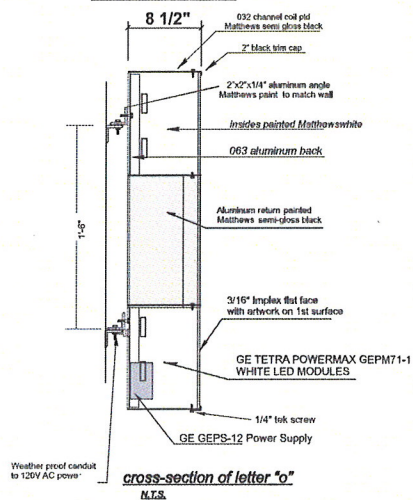

HINGE DETAIL

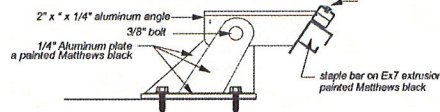

Section 'C'

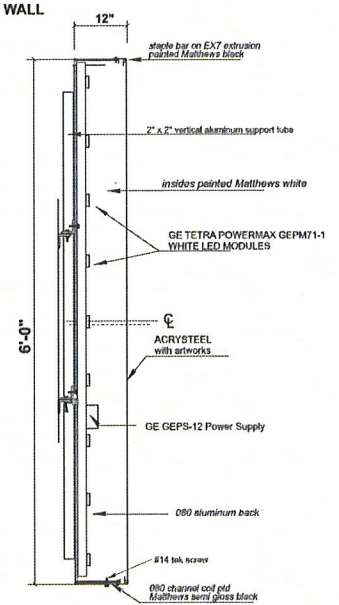

6'-0" LOGO - DETAILS

Manufacture and install... exterior

- One set of internally illuminated (self-contained) channel letters & round logo shape
- OVERALL SIZE: 6'-0" X 27'-0"

CONSTRUCTION

SUBSTRATE: Channel letters - 3/16" Implex flat face with vinyl and digital print first surface application
 Channel logo - Flex face with vinyl and digital print first surface application

CHANNELS, TRIMCAP & 1" RETAINER : Black
 ILLUMINATION: GE Tetra Powermax GEPM71-1 white LED modules
 SUPPORT STRUCTURE: 2" square tube frame (see construction drawings for details)...Aluminum

* SEE PROVIDED SITE CHECK FOR MORE DETAILS

PLEASE NOTE: SIZE OF SIGNAGE IS IN RELATION TO SURROUNDINGS IS APPROXIMATE. THIS OVERLAY IS INTENDED FOR LOCATION PURPOSES ONLY AND MAY NOT ACCURATELY REFLECT THE SCALE OF THE PROPOSED SIGN TO SURROUNDINGS. A SITE SURVEY IS REQUIRED FOR EXACT PROPORTIONS.

GRAPHICS

SAVE FOODS: Green face with 3D look green bevelled edges and black outline
 ON on circle bgkd: White face with 3D look white bevelled edges and black outline
 Circle graphics: Green face with 3D look green bevelled edges and black outline (retainer)

COLOUR DATA

- WHITE: Substrate
- GREEN: 3630-106 Brilliant Green Vinyl
- BLACK: Black painted returns & trimcap
- DIGITAL PRINT: 2x DIGITAL PRINTS ON CLEAR AND WHITE
- DIGITAL PRINT: DIGITAL PRINT ON CLEAR
- CLEAR OVERLAMINATE

ATLAS
 SIGN & AWNING
 26697 Gloucester Way, Langley, BC V4W 3S4
 Ph: (604) 856-7983 Fax: (604) 856-7625
 or call toll free (800) 882-1018

DATE: Dec 1, 2014
 JOB: 2859
 SALES: Lea Olom
 DESIGN: J Crouch
 SCALE: nts
 VOLTAGE: 120v
 PAGE: 3 of 3

Customer Approval

Development Variance Permit DVP00251
 2000 Island Highway North



Fluorescent, Neon and HID lamps contain Mercury. Dispose of these lamps according to Local, Provincial, State or Federal Laws.

Schedule C

Sign Detail

save on foods

SAVE ON FOODS - 947 Brooks Landing
 #103 - 2000 Island Hwy, Nanaimo BC V9S 5W3